

Quick Cable Reserves The Right to Alter Product Types, Their Technical Data, Dimensions, Style And Accessories Without Prior Notification.

Crimp Information

Hole For 5/16" [M8] Stud

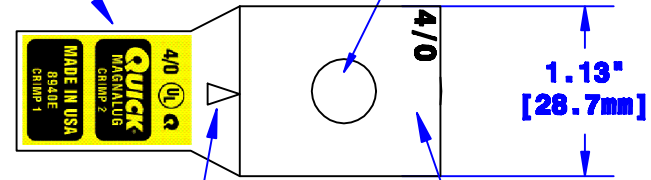

Sight Hole

Cable Size Stamp

ID Sized For 4/0
[103mm²] Stranded Cable
3/4" [19.1mm] Min Depth

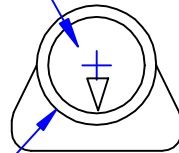

Ø.80"
[20.3mm]

Dia May Vary Due to
Manufacturing Process

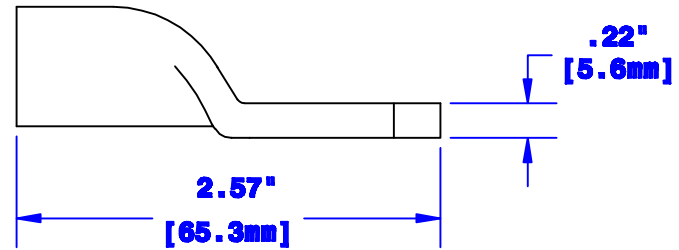

Property of QUICKCABLE 3700 Quick Drive Franksville, WI 53126 U.S.A. www.quickcable.com	TITLE 4/0 [103mm ²] Ind.Magna Lug W/ Sight Hole
	PART # 8940E

Confidential and Proprietary Information

					Drawn By Josh	Date 09-14-04	Checked By Mike E	Scale None	Material & Treatment Copper Tube Tin Plated	Drawing # 8940E-INFO	REV B	
B	01-30-12	2450	JMM	Redrawn; printing info updated	Tolerances, unless otherwise noted Dimensions are reference only					Sheet 1 of 1		
Rev	Date	ECN#	By	Description								