

Quick Cable Reserves The Right to Alter Product Types, Their Technical Data, Dimensions, Style And Accessories Without Prior Notification.

Crimp Information

Hole For 3/8" [M10] Stud

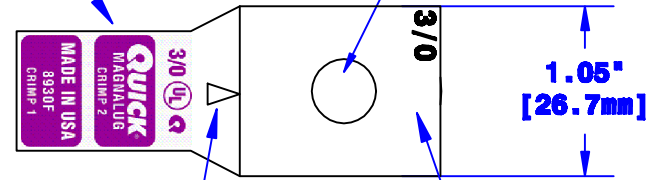

Sight Hole

Cable Size Stamp

ID Sized For 3/0 [81mm<sup>2</sup>] Stranded Cable  
3/4" [19.1mm] Min Depth

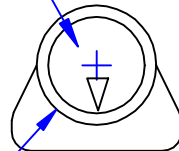

Ø.73" [18.5mm]

Dia May Vary Due to Manufacturing Process

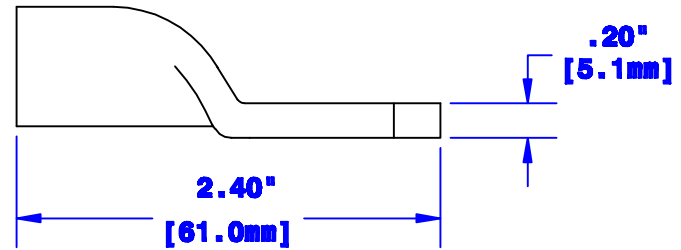

Property of <b>QUICKCABLE</b> 3700 Quick Drive Franksville, WI 53126 U.S.A. www.quickcable.com	TITLE	3/0 [81mm <sup>2</sup> ] Ind.Magna Lug W/ Sight Hole
	PART #	8930F

Confidential and Proprietary Information

Rev	Date	ECN#	By	Description	Drawn By	Date	Checked By	Scale
B	01-30-12	2450	JMM	Redrawn; printing info updated	Josh	09-14-04	Mike E	None
					Tolerances, unless otherwise noted Dimensions are reference only			

Material & Treatment	Drawing #	REV
Copper Tube Tin Plated	8930F-INFO	B
Sheet 1 of 1		