

Quick Cable Reserves The Right to Alter Product Types, Their Technical Data, Dimensions, Style And Accessories Without Prior Notification.

Crimp Information

Hole For 3/8" [M10] Stud

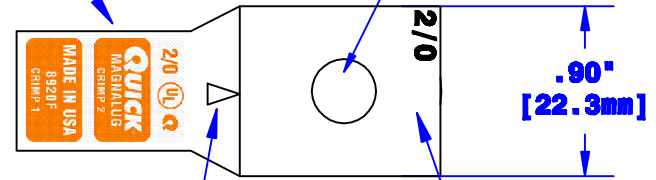

Sight Hole

Cable Size Stamp

ID Sized For 2/0 [62mm²] Stranded Cable
3/4" [19.1mm] Min Depth

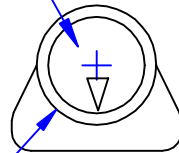

Ø.65"
[16.5mm]

Dia May Vary Due to Manufacturing Process

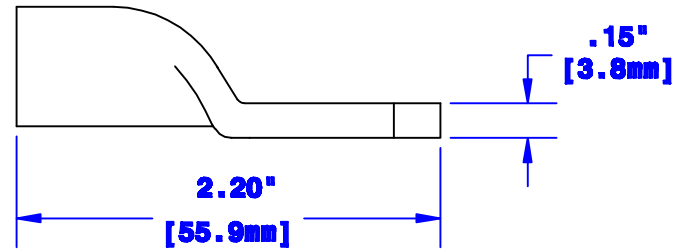

.15"
[3.8mm]

Property of QUICKCABLE 3700 Quick Drive Franksville, WI 53126 U.S.A. www.quickcable.com	TITLE 2/0 [62mm²] Ind.Magna Lug W/ Sight Hole
	PART # 8920F

Confidential and Proprietary Information

Rev	Date	ECN#	By	Description	Drawn By Josh	Date 09-14-04	Checked By Mike E	Scale None	Material & Treatment Copper Tube Tin Plated	Drawing # 8920F-INFO	REV B
B	01-30-12	2450	JMM	Redrawn; printing info updated	Tolerances, unless otherwise noted Dimensions are reference only					Sheet 1 of 1	