

Quick Cable Reserves The Right to Alter Product Types, Their Technical Data, Dimensions, Style And Accessories Without Prior Notification.

Crimp Information

Hole For 5/16" [M8] Stud

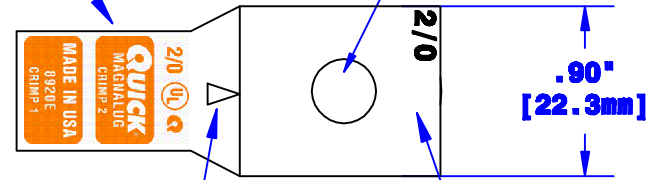

Sight Hole

Cable Size Stamp

ID Sized For 2/0 [62mm²] Stranded Cable
3/4" [19.1mm] Min Depth

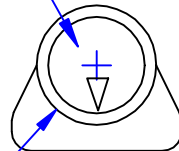

Ø.65" [16.5mm]

Dia May Vary Due to Manufacturing Process

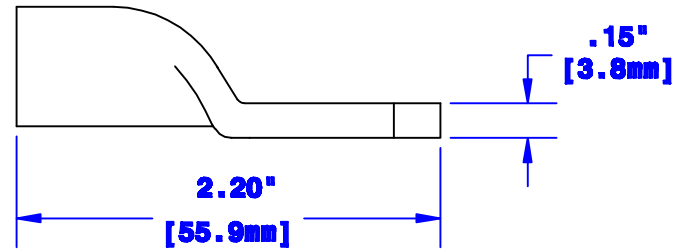

Property of		TITLE 2/0 [62mm ²]	
QUICKCABLE		Ind.Magna Lug	
3700 Quick Drive Franksville, WI 53126 U.S.A. www.quickcable.com		W/ Sight Hole	
		PART #	
		8920E	
Confidential and Proprietary Information			
Material & Treatment		Drawing #	
Copper Tube		8920E-INFO	
Tin Plated		REV	
		B	
		Sheet 1 of 1	

				Drawn By	Date	Checked By	Scale
				Josh	09-14-04	Mike E	None
				Tolerances, unless otherwise noted			
				Dimensions are reference only			
B	01-30-12	2450	JMM	Redrawn; printing info updated			
Rev	Date	ECN#	By	Description			