

Quick Cable Reserves The Right to Alter Product Types, Their Technical Data, Dimensions, Style And Accessories Without Prior Notification.

Crimp Information

Hole For 5/16" [M8] Stud

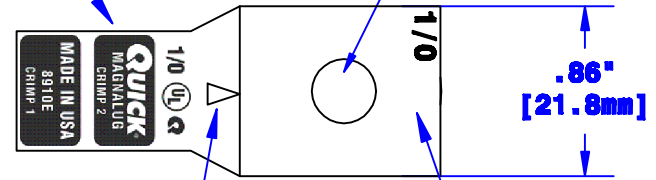

Sight Hole

Cable Size Stamp

ID Sized For 1/0 [50mm<sup>2</sup>] Stranded Cable  
3/4" [19.1mm] Min Depth

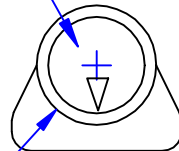

Ø.62" [15.7mm]

Dia May Vary Due to Manufacturing Process

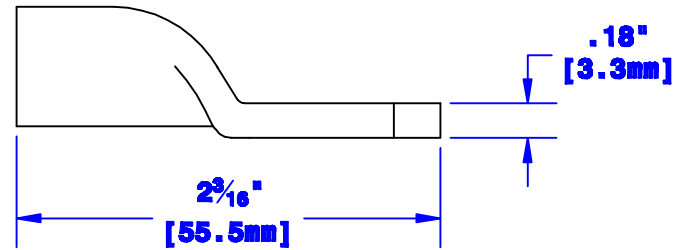

Property of <b>QUICKCABLE</b> 3700 Quick Drive Franksville, WI 53126 U.S.A. www.quickcable.com		TITLE <b>1/0 [50mm<sup>2</sup>] Ind.Magna Lug W/ Sight Hole</b>
		PART # <b>8910E</b>
<b>Confidential and Proprietary Information</b>		
Material & Treatment <b>Copper Tube Tin Plated</b>	Drawing # <b>8910E-INFO</b>	REV <b>B</b>
		Sheet 1 of 1

Rev	Date	ECN#	By	Description	Drawn By <b>Josh</b>	Date <b>09-14-04</b>	Checked By <b>Mike E</b>	Scale <b>None</b>
<b>B</b>	<b>01-30-12</b>	<b>2450</b>	<b>JMM</b>	<b>Redrawn; printing info updated</b>	Tolerances, unless otherwise noted <b>Dimensions are reference only</b>			