

Quick Cable Reserves The Right to Alter Product Types, Their Technical Data, Dimensions, Style And Accessories Without Prior Notification.

Crimp Information

Hole For 5/16" [M8] Stud

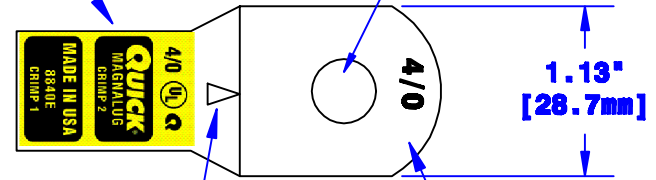

Sight Hole

Cable Size Stamp

ID Sized For 4/0 [103mm²] Stranded Cable
3/4" [19.1mm] Min Depth

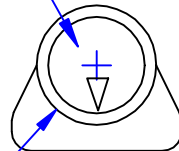

0.8" [20.3mm]

Dia May Vary Due to Manufacturing Process

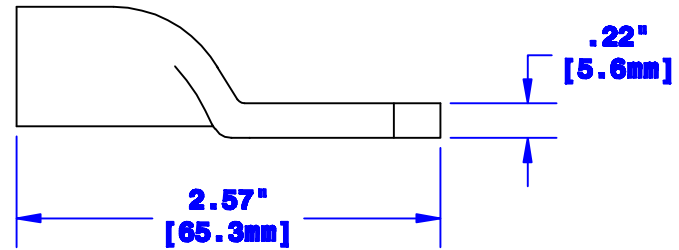

Property of QUICKCABLE 3700 Quick Drive Franksville, WI 53126 U.S.A. www.quickcable.com		TITLE 4/0 [103mm²] Magna Lug W/ Sight Hole
PART # 8840E		
Confidential and Proprietary Information		
Material & Treatment Copper Tube Tin Plated	Drawing # 8840E-INFO	REV C
Sheet 1 of 1		

Drawn By Paul	Date 03-12-03	Checked By Mike E	Scale None
Tolerances, unless otherwise noted Dimensions are reference only			
Rev C	Date 01-30-12	ECN# 2450	By JMM
Description Redrawn; printing info updated			