

Quick Cable Reserves The Right to Alter Product Types, Their Technical Data, Dimensions, Style And Accessories Without Prior Notification.

Crimp Information

Hole For 3/8" [M10] Stud

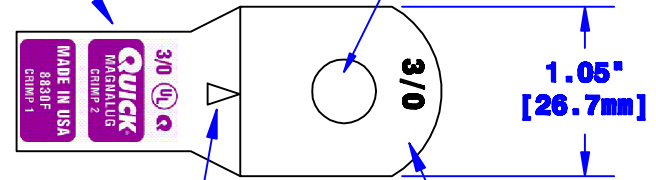

Sight Hole

Cable Size Stamp

ID Sized For 3/0 [81mm²] Stranded Cable
3/4" [19.1mm] Min Depth

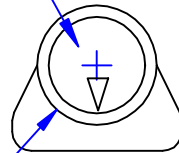

Ø.73" [18.5mm]

Dia May Vary Due to Manufacturing Process

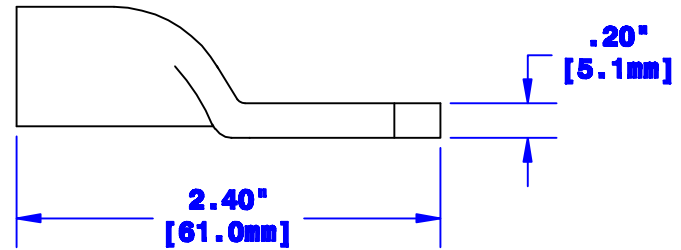

Property of QUICKCABLE 3700 Quick Drive Franksville, WI 53126 U.S.A. www.quickcable.com	TITLE 3/0 [81mm²] Magna Lug W/ Sight Hole
	PART # 8830F

Confidential and Proprietary Information

					Drawn By Paul	Date 03-12-03	Checked By Mike E	Scale None	Material & Treatment Copper Tube Tin Plated	Drawing # 8830F-INFO	REV B
B	01-30-12	2450	JMN	Redrawn; printing info updated	Tolerances, unless otherwise noted Dimensions are reference only					Sheet 1 of 1	
Rev	Date	ECN#	By	Description							