

Quick Cable Reserves The Right to Alter Product Types, Their Technical Data, Dimensions, Style And Accessories Without Prior Notification.

Crimp Information

Hole For 1/4" [M6] Stud

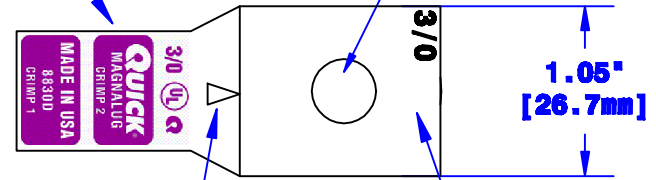

Sight Hole

Cable Size Stamp

ID Sized For 3/0 [81mm<sup>2</sup>] Stranded Cable  
3/4" [19.1mm] Min Depth

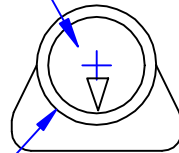

Ø.73" [18.5mm]

Dia May Vary Due to Manufacturing Process

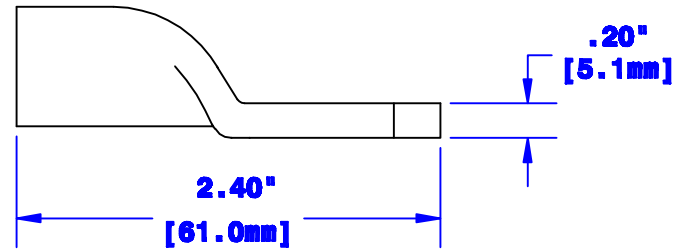

Property of <b>QUICKCABLE</b> 3700 Quick Drive Franksville, WI 53126 U.S.A. www.quickcable.com	TITLE <b>3/0 [81mm<sup>2</sup>] Ind.Magna Lug W/ Sight Hole</b>
	PART # <b>8930D</b>

**Confidential and Proprietary Information**

					Drawn By <b>Josh</b>	Date <b>09-14-04</b>	Checked By <b>Mike E</b>	Scale <b>None</b>	Material & Treatment <b>Copper Tube Tin Plated</b>	Drawing # <b>8930D-INFO</b>	REV <b>B</b>
<b>B</b>	<b>01-30-12</b>	<b>2450</b>	<b>JMM</b>	<b>Redrawn; printing info updated</b>	Tolerances, unless otherwise noted <b>Dimensions are reference only</b>					Sheet <b>1</b> of <b>1</b>	
Rev	Date	ECN#	By	Description							