

Quick Cable Reserves The Right to Alter Product Types, Their Technical Data, Dimensions, Style And Accessories Without Prior Notification.

Crimp Information

Hole For 5/16" [M8] Stud

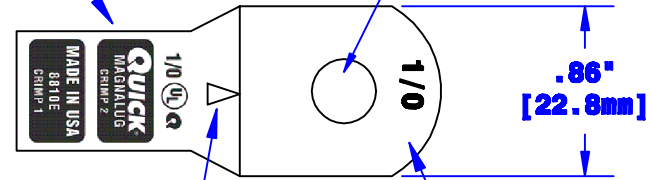

Sight Hole

Cable Size Stamp

ID Sized For 1/0 [50mm²] Stranded Cable
5/8" [15.9mm] Min Depth

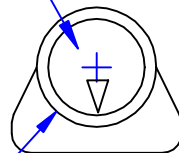

Ø.62" [15.7mm]

Dia May Vary Due to Manufacturing Process

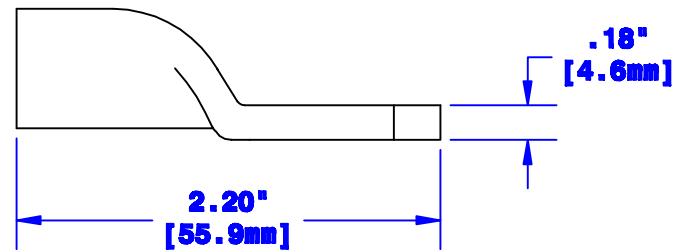

Property of QUICKCABLE 3700 Quick Drive Franksville, WI 53126 U.S.A. www.quickcable.com		TITLE 1/0 [50mm²] Magna Lug W/ Sight Hole
		PART # 8810E
Confidential and Proprietary Information		
Material & Treatment Copper Tube Tin Plated	Drawing # 8810E-INFO	REV B
		Sheet 1 of 1

Rev	Date	ECN#	By	Description	Drawn By Paul	Date 03-12-03	Checked By Mike E	Scale None
B	01-30-12	2450	JMM	Redrawn; printing info updated	Tolerances, unless otherwise noted Dimensions are reference only			