

Quick Cable Reserves The Right to Alter Product Types, Their Technical Data, Dimensions, Style And Accessories Without Prior Notification.

Crimp Information

Hole For 5/16" [M8] Stud

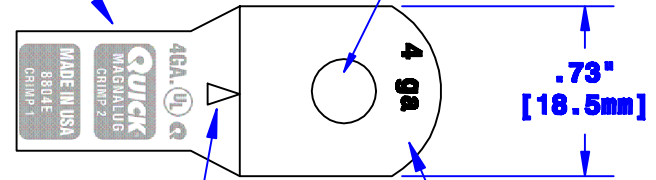

Sight Hole

Cable Size Stamp

ID Sized For 4 Ga
[19mm²] Stranded Cable
5/8" [15.9mm] Min Depth

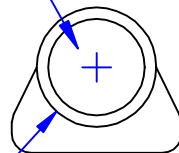

Ø.40"
[10.2mm]

Dia May Vary Due to
Manufacturing Process

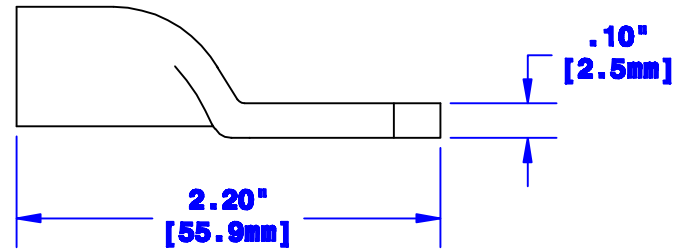

Property of QUICKCABLE 3700 Quick Drive Franksville, WI 53126 U.S.A. www.quickcable.com		TITLE 4 ga [19mm²] Magna Lug W/ Sight Hole
PART # 8804E		
Confidential and Proprietary Information		
Material & Treatment Copper Tube Tin Plated	Drawing # 8804E-INFO	REV B
Sheet 1 of 1		

Rev	Date	ECN#	By	Description	Drawn By Paul	Date 03-12-03	Checked By Mike E	Scale None
B	01-30-12	2450	JMM	Redrawn; printing info updated	Tolerances, unless otherwise noted Dimensions are reference only			