

Quick Cable Reserves The Right to Alter Product Types, Their Technical Data, Dimensions, Style And Accessories Without Prior Notification.

Crimp Information

Hole For 1/2" [M12] Stud

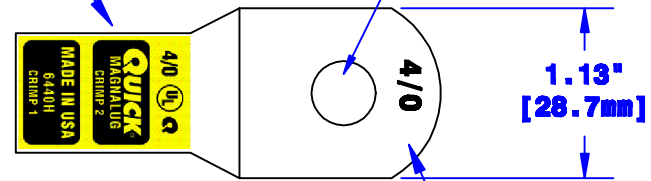

Cable Size Stamp

**ID Sized For 4/0
[103mm²] Stranded Cable
3/4" [19.1mm] Min Depth**

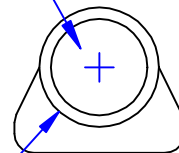

**Ø.8"
[20.3mm]**

**Dia May Vary Due to
Manufacturing Process**

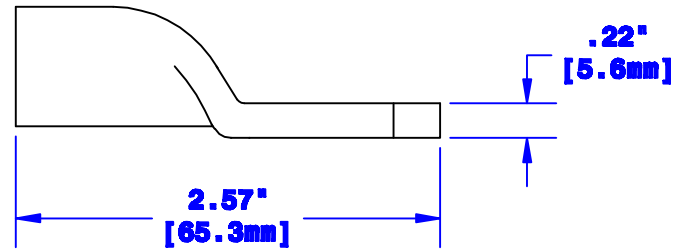

Property of QUICKCABLE® 3700 Quick Drive Franksville, WI 53126 U.S.A. www.quickcable.com		TITLE 4/0 [103mm²] Magna Lug
		PART # 6440H
Confidential and Proprietary Information		
Material & Treatment Copper Tube Tin Plated	Drawing # 6440H-INFO	REV C
		Sheet 1 of 1

				Drawn By Paul	Date 03-12-03	Checked By Mike E	Scale None
Rev	Date	ECH#	By	Description			
C	01-30-12	2450	JMM	Redrawn; printing info updated			
Tolerances, unless otherwise noted							
Dimensions are reference only							