

Quick Cable Reserves The Right to Alter Product Types, Their Technical Data, Dimensions, Style And Accessories Without Prior Notification.

Crimp Information

Hole For 3/8" [M10] Stud

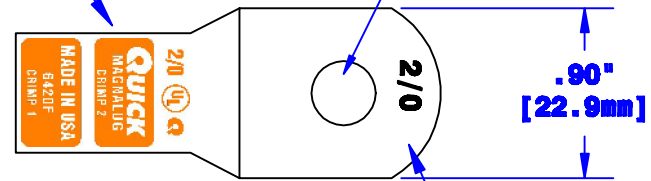

Cable Size Stamp

ID Sized For 2/0
[62mm²] Stranded Cable
3/4" [19.1mm] Min Depth

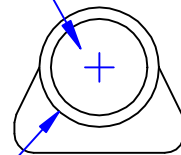

Ø.655"
[16.5mm]

Dia May Vary Due to
Manufacturing Process

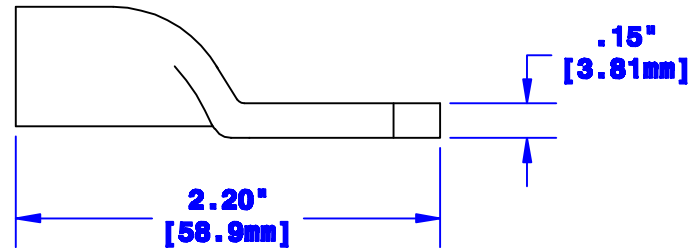

Property of QUICKCABLE 3700 Quick Drive Franksville, WI 53126 U.S.A. www.quickcable.com		TITLE 2/0 [62mm²] Magna Lug
CONFIDENTIAL AND PROPRIETARY INFORMATION		PART # 6420F
Material & Treatment Copper Tube Tin Plated	Drawing # 6420F-INFO	REV B
Sheet 1 of 1		

Rev	Date	ECH#	By	Description	Drawn By Paul	Date 03-12-03	Checked By Mike E	Scale None
B	01-30-12	2450	JMM	Redrawn; printing info updated	Tolerances, unless otherwise noted Dimensions are reference only			