

Quick Cable Reserves The Right to Alter Product Types, Their Technical Data, Dimensions, Style And Accessories Without Prior Notification.

Crimp Information

Hole For 5/16" [M8] Stud

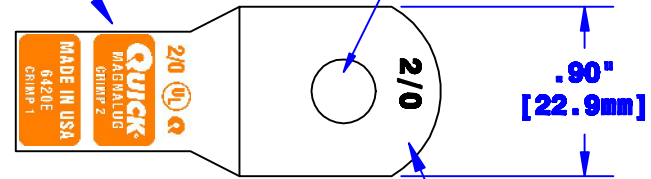

Cable Size Stamp

ID Sized For 2/0 [62mm²] Stranded Cable
3/4" [19.1mm] Min Depth

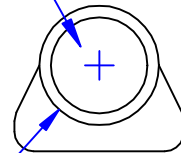

Ø.655" [16.5mm]

Dia May Vary Due to Manufacturing Process

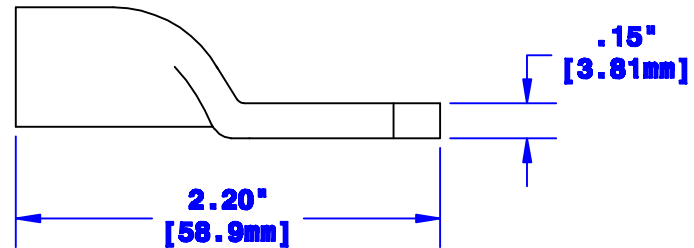

Property of QUICKCABLE® 3700 Quick Drive Franksville, WI 53126 U.S.A. www.quickcable.com		TITLE 2/0 [62mm²] Magna Lug
		PART # 6420E
Confidential and Proprietary Information		
Material & Treatment Copper Tube Tin Plated	Drawing # 6420E-INFO	REV B
		Sheet 1 of 1

Rev	Date	ECH#	By	Description	Drawn By	Date	Checked By	Scale
B	01-30-12	2450	JMM	Redrawn; printing info updated	Paul	03-12-03	Mike E	None
					Tolerances, unless otherwise noted Dimensions are reference only			