

Quick Cable Reserves The Right to Alter Product Types, Their Technical Data, Dimensions, Style And Accessories Without Prior Notification.

**Crimp Information**

**Hole For 1/4" [M6] Stud**

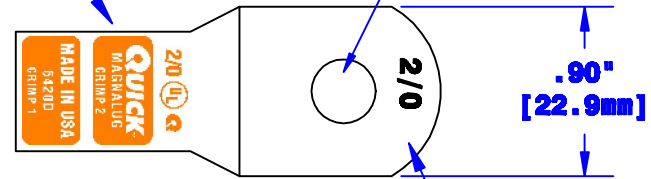

**Cable Size Stamp**

**ID Sized For 2/0  
[62mm<sup>2</sup>] Stranded Cable  
3/4" [19.1mm] Min Depth**

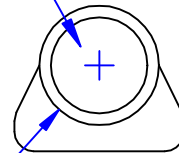

**Ø.655"  
[16.5mm]**

**Dia May Vary Due to  
Manufacturing Process**

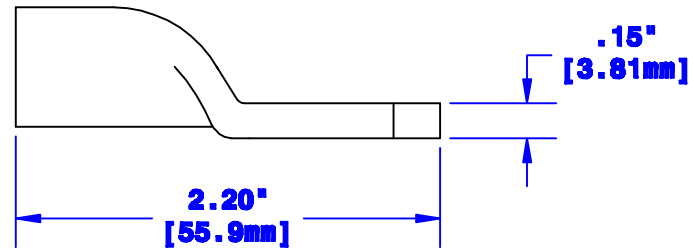

<b>Property of</b> <b>QUICKCABLE®</b> 3700 Quick Drive Franksville, WI 53126 U.S.A. www.quickcable.com		<b>TITLE</b> <b>2/0 [62mm<sup>2</sup>]          Magna Lug</b>	
		<b>PART #</b> <b>6420D</b>	
<b>Confidential and Proprietary Information</b>			
<b>Material &amp; Treatment</b> <b>Copper Tube          Tin Plated</b>		<b>Drawing #</b> <b>6420D-INFO</b>	
		<b>REV</b> <b>B</b>	
		Sheet 1 of 1	

Rev	Date	ECH#	By	Description	Drawn By	Date	Checked By	Scale
B	01-30-12	2450	JMM	Redrawn; printing info updated	Paul	03-12-03	Mike E None	
					Tolerances, unless otherwise noted Dimensions are reference only			