

Quick Cable Reserves The Right to Alter Product Types, Their Technical Data, Dimensions, Style And Accessories Without Prior Notification.

Crimp Information

Hole For 3/8" [M10] Stud

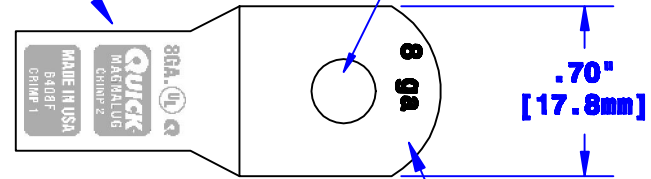

Cable Size Stamp

ID Sized For 8 Ga
[8mm²] Stranded Cable
3/4" [19.1mm] Min Depth

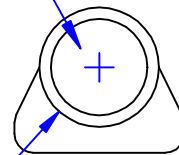

Ø.35"
[8.9mm]

Dia May Vary Due to
Manufacturing Process

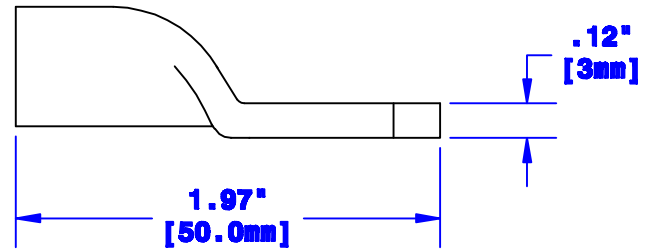

Property of QUICKCABLE 3700 Quick Drive Franksville, WI 53126 U.S.A. www.quickcable.com		TITLE 8 Ga [8mm²] Magna Lug
PART # 6408F		
Confidential and Proprietary Information		
Material & Treatment Copper Tube Tin Plated	Drawing # 6408F-INFO	REV B
Sheet 1 of 1		

Drawn By Paul	Date 03-12-03	Checked By Mike E	Scale None
Tolerances, unless otherwise noted Dimensions are reference only			
Rev B	Date 01-30-12	ECH# 2450	By JMM
Description Redrawn; printing info updated			