

Quick Cable Reserves The Right to Alter Product Types, Their Technical Data, Dimensions, Style And Accessories Without Prior Notification.

Crimp Information

Hole For 1/16" [M8] Stud

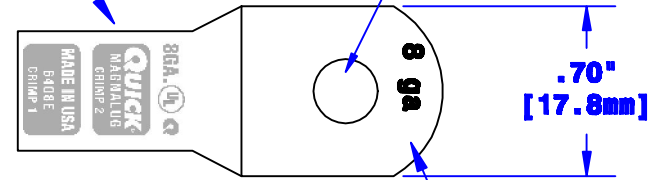

Cable Size Stamp

**ID Sized For 8 Ga
[8mm²] Stranded Cable
3/4" [19.1mm] Min Depth**

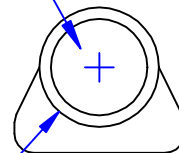

**0.35"
[8.9mm]**

**Dia May Vary Due to
Manufacturing Process**

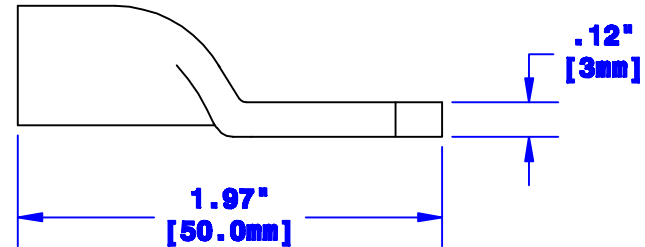

**.12"
[3mm]**

**1.97"
[50.0mm]**

Property of QUICKCABLE® 3700 Quick Drive Franksville, WI 53126 U.S.A. www.quickcable.com		TITLE 8 Ga [8mm²] Magna Lug	
		PART # 6408E	
Confidential and Proprietary Information			
Material & Treatment Copper Tube Tin Plated		Drawing # 6408E-INFO	REV B
		Sheet 1 of 1	

Rev	Date	ECH#	By	Description	Drawn By	Date	Checked By	Scale
B	01-30-12	2450	JMM	Redrawn; printing info updated	Paul	03-12-03	Mike E	None
					Tolerances, unless otherwise noted Dimensions are reference only			