

Quick Cable Reserves The Right to Alter Product Types, Their Technical Data, Dimensions, Style And Accessories Without Prior Notification.

Crimp Information

Hole For 1/2" [M12] Stud

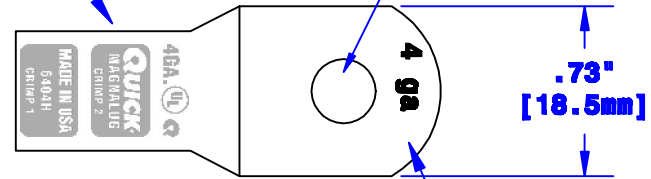

Cable Size Stamp

**ID Sized For 4 Ga
[19mm²] Stranded Cable
3/4" [19.1mm] Min Depth**

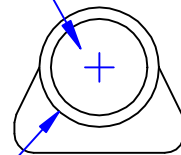

**Ø.40"
[10.2mm]**

**Dia May Vary Due to
Manufacturing Process**

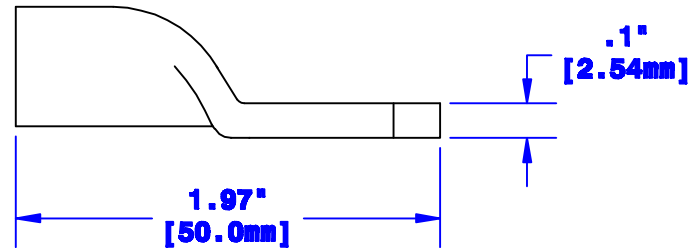

Property of QUICKCABLE 3700 Quick Drive Franksville, WI 53126 U.S.A. www.quickcable.com		TITLE 4 Ga [19mm²] Magna Lug
PART # 6404H		
Confidential and Proprietary Information		
Material & Treatment Copper Tube Tin Plated	Drawing # 6404H-INFO	REV C
Sheet 1 of 1		

Drawn By Paul	Date 03-12-03	Checked By Mike E	Scale None
Tolerances, unless otherwise noted Dimensions are reference only			
C 01-30-12	2450	JMM	Redrawn; printing info updated
Rev	Date	ECH#	By Description