

Quick Cable Reserves The Right to Alter Product Types, Their Technical Data, Dimensions, Style And Accessories Without Prior Notification.

Crimp Information

Hole For 3/8" [M10] Stud

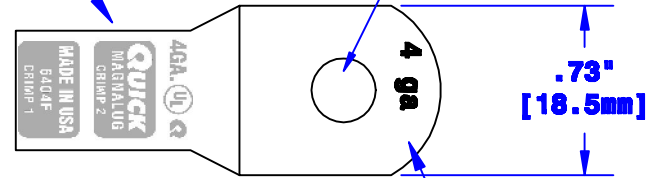

Cable Size Stamp

**ID Sized For 4 Ga
[19mm²] Stranded Cable
3/4" [19.1mm] Min Depth**

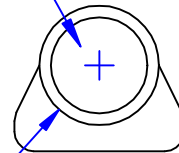

**Ø.40"
[10.2mm]**

**Dia May Vary Due to
Manufacturing Process**

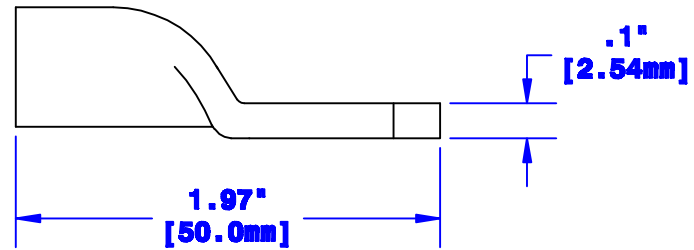

Property of QUICKCABLE® 3700 Quick Drive Franksville, WI 53126 U.S.A. www.quickcable.com		TITLE 4 Ga [19mm²] Magna Lug	
		PART # 6404F	
Confidential and Proprietary Information			
Material & Treatment Copper Tube Tin Plated		Drawing # 6404F-INFO	
		REV C	
		Sheet 1 of 1	

Rev	Date	ECH#	By	Description	Drawn By	Date	Checked By	Scale
					Paul	03-12-03	Mike E None	
					Tolerances, unless otherwise noted Dimensions are reference only			