

Quick Cable Reserves The Right to Alter Product Types, Their Technical Data, Dimensions, Style And Accessories Without Prior Notification.

Crimp Information

Hole For 1/2" [M12] Stud

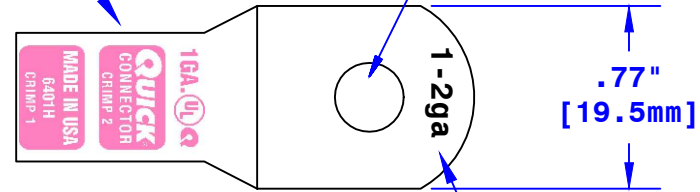

Cable Size Stamp

ID Sized For 1 or 2 Ga  
[40-32mm<sup>2</sup>] Stranded Cable  
3/4" [19.1mm] Min Depth

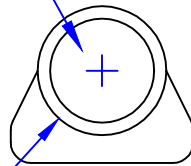

Ø.55"  
[14mm]

Dia May Vary Due to Manufacturing Process

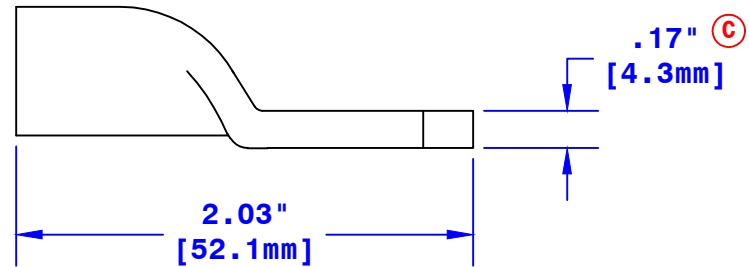

|   |  |
|---|--|
| Property of<br><b>QUICKCABLE</b><br>3700 Quick Drive<br>Franksville, WI 53126<br>U.S.A.<br>www.quickcable.com | TITLE                                    |
|   | 1&2 Ga [40-32mm <sup>2</sup> ] Magna Lug |
|   | PART #                                   |
|   | 6401H                                    |

Confidential and Proprietary Information

|          |          |      |     |                                |                                    |                 |               |             |                      |           |      |
|----------|----------|------|-----|--------------------------------|------------------------------------|-----------------|---------------|-------------|----------------------|-----------|------|
|          |          |      |     |                                | Drawn By                           | Date            | Checked By    | Scale       | Material & Treatment | Drawing # | REV  |
| <b>C</b> | 05-08-14 | 3037 | MRE | Updated dimension              | <b>Paul</b>                        | <b>03-12-03</b> | <b>Mike E</b> | <b>None</b> |                      |           |      |
| <b>B</b> | 01-30-12 | 2459 | JMH | Redrawn; printing info updated | Tolerances, unless otherwise noted |                 |               |             |                      |           |      |
| Rev      | Date     | ECN# | By  | Description                    | Dimensions are reference only      |                 |               |             |                      | Sheet 1   | Of 1 |