

Quick Cable Reserves The Right to Alter Product Types, Their Technical Data, Dimensions, Style And Accessories Without Prior Notification.

I.D. Sized For 250 MCM [126mm²] Stranded Cable

27/32" O.D. [21.4mm] (May Vary Due To Shrinkage)

Bolt Hole Sized For 5/16" [M8] Bolt

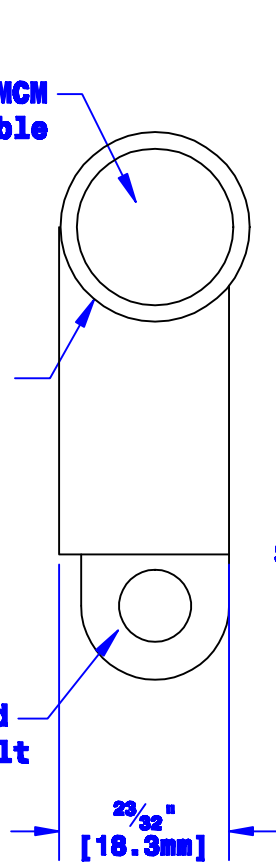

2-1/2" [63.5mm]

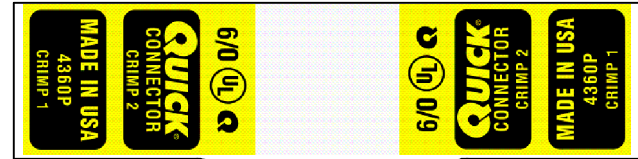

Crimp Information

Sized For Pos. Post Per SAE J537

Polarity Stamp

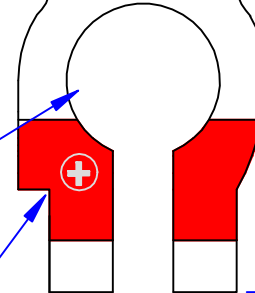

2-17/64" [57.5mm]

| | | |
|---|--------------------------------|--|
| Property of QUICKCABLE 3700 Quick Drive Franksville, WI 53126 U.S.A. www.quickcable.com | | TITLE Die Cast Flag 250 MCM[126mm²], Pos. |
| CONFIDENTIAL AND PROPRIETARY INFORMATION | | PART # 4360P |
| Material & Treatment High Conductivity Copper Alloy Tin Plated | Drawing # 4360P-Info | REV B |
| Sheet 1 of 1 | | |

| | | | | | | | | |
|----------|-----------------|-------------|------------|---------------------------------------|---|-------------------------|-----------------------------|----------------------|
| Rev | Date | ECH# | By | Description | Drawn By Jim H | Date 12-22-03 | Checked By Mike E | Scale None |
| B | 08-07-12 | 2459 | JMH | Redrawn; printing info updated | Tolerances, unless otherwise noted Dimensions are reference only | | | |