

**ID Sized For 4 Ga.
[19mm²] Stranded Cable
3/4" [19.1mm] Min Depth**

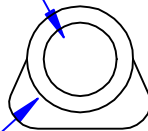

**.40" Dia.
[10mm]**

**Dia May Vary Due To
Manufacturing Process**

Slotted For Locking Screw

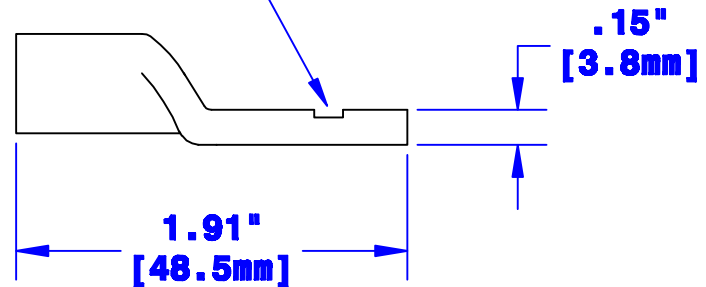

Property of QUICKCABLE® 3700 Quick Drive Franksville, WI 53126 U.S.A. www.quickcable.com		TITLE 4 Ga [19mm²] Magna Lug, Inverter	
		PART # 102804	
Confidential and Proprietary Information			
Material & Treatment 100% Copper Tin Plated		Drawing # 102804-Info	
		Sheet 1 of 1	

					Drawn By	Date	Checked By	Scale
					Jim H	02-03-09	Mike E	None
					Tolerances, unless otherwise noted			
					Dimensions are reference only			
Rev	Date	ECN#	By	Description				