

Printed Crimp Information

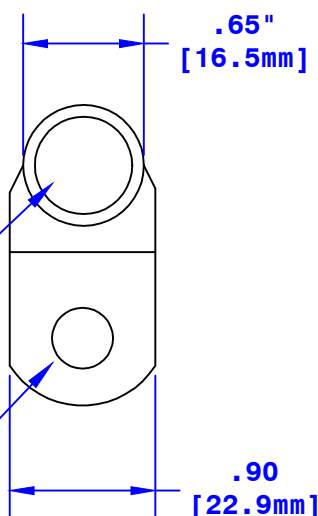

ID Sized For 2/0
[62mm²] Stranded Cable
3/4" [19mm] Min Depth

Hole Sized For 3/8" [M10] Stud



Dia May Vary Due to
Manufacturing Process

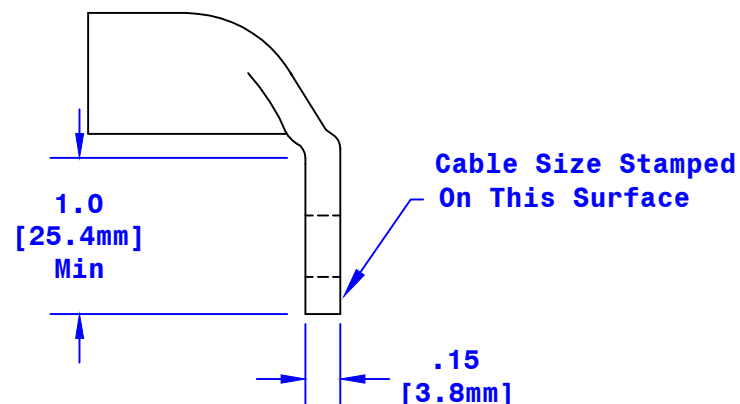

Property of QUICKCABLE® 3700 Quick Drive Franksville, WI 53126 U.S.A. www.quickcable.com		TITLE 2/0 Ga [62mm ²] 90° 3/8" [M10] Hole	
		PART # 6420FL	
Confidential and Proprietary Information			
Material & Treatment Copper Tube Tin Plated	Drawing # 6420FL-Info		REV B
	Sheet 1 of 1		

Rev	Date	ECN#	By	Description	Drawn By	Date	Checked By	Scale
B	04-10-12	2459	JMH	Redrawn; printing info updated	Kirk A	10-24-07	Mike E	None
					Tolerances, unless otherwise noted			
					Dimensions are reference only			