

Printed Crimp Information

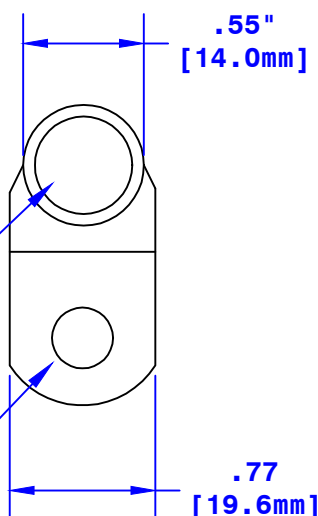

ID Sized For 1 or 2 Ga
[40-32mm²] Stranded Cable
3/4" [19.1mm] Min Depth

Hole Sized For 3/8" [M10] Stud



Dia May Vary Due to
Manufacturing Process

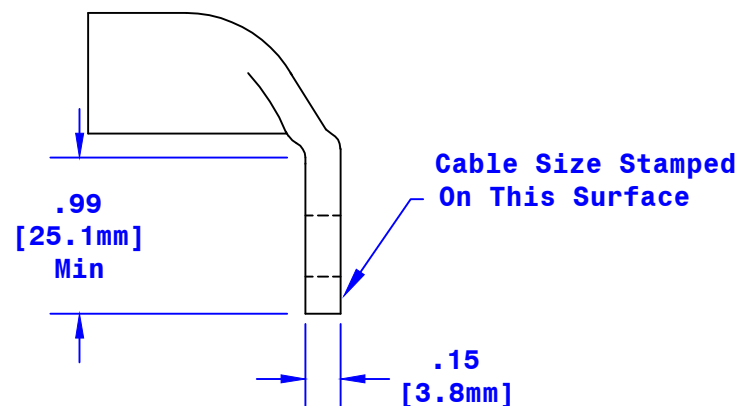

Property of QUICKCABLE® 3700 Quick Drive Franksville, WI 53126 U.S.A. www.quickcable.com		TITLE 1&2 Ga [40-32mm ²] 90° 3/8" [M10] Hole	
		PART # 6401FL	
Confidential and Proprietary Information			
Material & Treatment Copper Tube Tin Plated	Drawing # 6401FL-Info		REV B
	Sheet 1 of 1		

Rev	Date	ECN#	By	Description	Drawn By	Date	Checked By	Scale
B	04-02-12	2459	JMH	Redrawn; printing info updated	Kirk A	09-20-07	Mike E	None
					Tolerances, unless otherwise noted			
					Dimensions are reference only			