

Detail A Typ

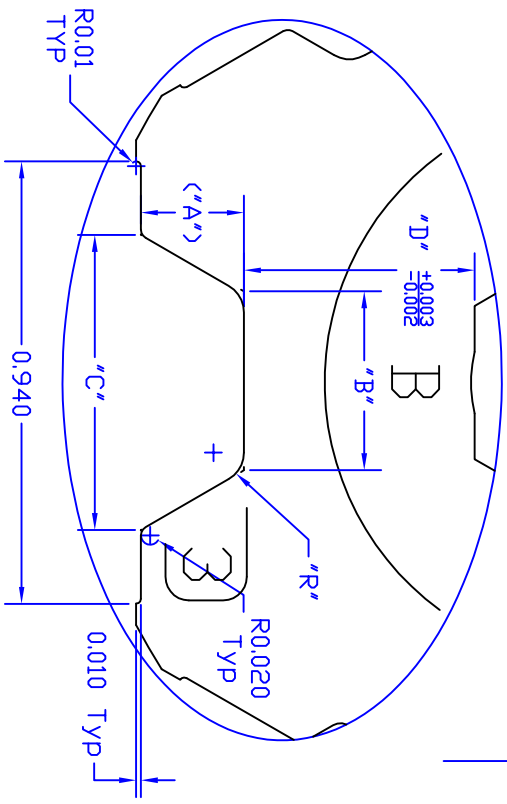

Detail A 3x Scale

Die Pocket Dimensions		<Detail A>			
Pocket	A (IN)	B (IN)	C (IN)	D (IN)	R (IN)
1	0.261	0.508	0.810	0.446	0.095
2	0.231	0.470	0.736	0.477	0.095
3	0.219	0.373	0.626	0.485	0.095
4	0.174	0.435	0.637	0.535	0.065
5	0.184	0.324	0.537	0.524	0.065
6	0.148	0.375	0.546	0.560	0.065

Notes:

Pocket numbers are 0.10" high and 0.015" Deep.

No Burrs or Sharp Edges

All Hex Hole Surfaces and Pocket Surfaces Inside the "C" Dimension are to be Full Shear.

Rev	Date	ECN#	By	Description
H	5/7/15	3253	BMT	Was Bead Blast and Nickle Plate
G	9/25/14	2873	BMT	0.566 was 0.565, Added 0.581 Max Dia. 4140 was 1045
F	11/26/13	2873	BMT	Changes To Match As Manufactured Part

Drawn By	Date	Checked By	Scale
BMT	6/6/12	Mike E	None

Tolerances, unless otherwise noted
2 Place Dec. ± .010"
3 Place Dec. ± .002"

Property of
QUICKCABLE
3700 Quick Drive
Franksville, WI 53126
U.S.A.
www.quickcable.com

Part #
4255UDB

Material & Treatment
4140 Steel
42-46 Rc
Plate Clear Zinc
TriValent Chromate

Confidential and Proprietary Information

TITLE
Universal Die B

Drawing #
4255UDB

Sheet **1** of **1**

REV
H